

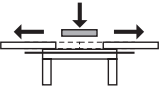

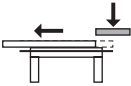
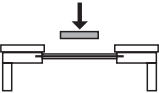
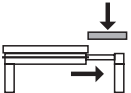

		Type of leaf						Pull out					Accessories	Page			
		Additional extension leaves				Folding extension leaf		Synchronous	Asynchronous	Front extension	With support leg	Self-supporting			Folding table fitting		
		1	2	3	4	1	2										
Tables with frame																	
		✓	✓					✓	✓				✓	► FF 11.12			
		✓						✓	✓				✓	► FF 11.13			
		✓						✓					✓	► FF 11.14			
		✓	✓	✓	✓			✓					✓	► FF 11.18			
Tables without frame																	
		✓	✓	✓	✓			✓						► FF 11.18			
					✓				✓		✓			► FF 11.19			
		✓	✓						✓					► FF 11.20			
		✓	✓	✓					✓					► FF 11.21			
						✓	✓			✓				► FF 11.22			
Pull out systems for installation in cabinets																	
						✓					✓		► FF 11.23				
						✓				✓			► FF 11.24				
Table extension fittings																	
	✓											✓	► FF 11.25				
	✓											✓	► FF 11.26				
	✓											✓	► FF 11.27				

### Table with or without frame

Table bases with and without frames are constructed and function in different ways.

#### Table with frame = one-piece table base

The separable table tops are pushed apart.  
The table base remains unchanged.

#### Table without frame = multi-piece table base

The separable table bases with fixed table top are pushed apart.

Following applies for both tables with frame and without frame:

#### Extension leaf

Minimum width 400 mm

Standard 500 mm

Comfort 600 mm

One extension leaf provides additional seating for 2 people.

#### Synchronous

Only one table side must be pulled out. The opposite side of the table is then extended automatically.

#### Asynchronous

Both table sides must be pulled out separately.

#### Without locking mechanism

For locking the pull out table fitting in extended position additional fittings are required (swivel lugs, locking hooks or spring clips).

#### With locking mechanism

The locking mechanism is integrated in the pull out table fitting.  
No further fittings are required.

## Pull out table fittings for tables with frame

### Construction

- > One-piece table base
- > Separate table tops and extension leaves with table top connecting fittings and sleeves
- > Extension leaves can be fitted to the table frame with a folding fitting.

#### Notes on construction

- > Pull out tables with closed frames can also be equipped with an extension leaf with a hinged middle section (folding fitting). The folding fitting is required in addition to the pull out table fitting and must be ordered separately.

#### Note on choice of pull out table fitting

- > Installation length L of pull out table fitting = approx. length of frame/base or approx. 2/3 of table Ø or table length without extension leaves

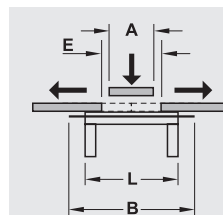

A = width of extension leaf  
L = installation length of pull out table fitting  
B = total extension length of pull out table fitting  
E = opening for extension leaf

Please note:

If the installation length L is less than approx. length of frame/base or table Ø, this may lead to malfunction or sagging of the table top.

### Types of tables with frame

Open table frame	Closed table frame	Separate extension leaf on end side	Front extension	Front extension
Separate extension leaf > Separate extension leaf (separate storage)	Folding fitting > Separate extension leaf (integrated in table) > Folding fitting (integrated in table)		> Open table frame > Folding fitting (integrated in table)	> Folding fitting (integrated in table, "drawer function")

Note: Folding fitting must be ordered separately in addition to the pull out table fitting.

## Pull out table fittings for tables without frame

### Construction

- > Multi-piece table base, each fixed to one half of the table top.
- > Surrounding panel beneath table top stabilises the pull out table.

#### Notes on construction

- > If the table legs are mounted inwards (with balance point on table top half), the pull out table fitting can be used without a central rod.
- > If table legs are mounted outwards, always select pull out table fitting with central rod.

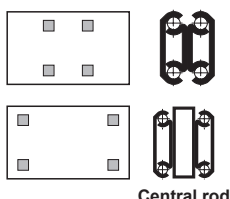

Central rod

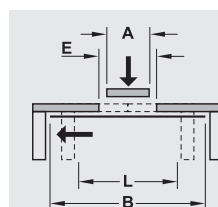

A = width of extension leaf  
L = installation length of pull out table fitting  
B = total extension length of pull out table fitting  
E = opening for extension leaf  
Ⓐ Installation length of pull out table fitting is approx. length of frame

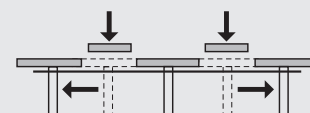

View of table from below, without extension leaf

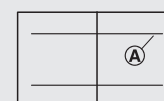

#### Note on choice of pull out table fitting

- > Installation length L of pull out table fitting = approx. length of frame/base or approx. 2/3 of table Ø or table length without extension leaves

Please note:

If the installation length L is less than approx. length of frame/base or 2/3 of table Ø, this may lead to malfunction or sagging of the table top.

### Types of tables without frame

Open table frame	Front extension
> Separate extension leaf (separate storage)	> Open table frame > Separate extension leaf (separate storage)

## Ball bearing runners

- > Material: Steel
- > Finish: Galvanized
- > Installation: For screw fixing

### → For 1 extension leaf

Synchronous, asynchronous or synchronous with continuous, lateral locking mechanism



For 2 people more at the table



### Installation

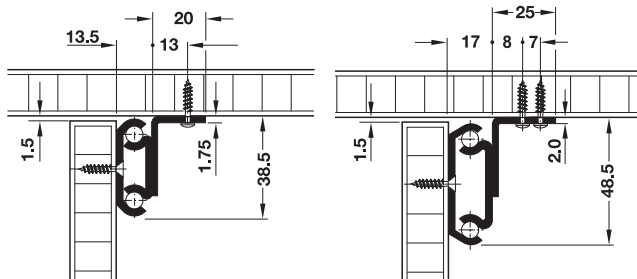

Load bearing capacity 60 kg

Load bearing capacity 90 kg

### Technical data

Installation length	mm	850	1200
Load bearing capacity	kg	60	90
Opening for extension leaf	mm	640	890
Width of extension leaf	mm	1 x 600	2 x 400
Total extension length	mm	1250	1830
Mounting bracket length	mm	290	338
Recommended table length	mm	900–1200	1250–1800

### Note on choice of pull out table fitting

Installation length of pull out table fitting = approx. length of frame/ base or approx. 2/3 of table diameter or table length without extension leaves

Installation length mm	Load bearing capacity kg	Version	Cat. No.
850	60	Synchronous	642.59.902
		Asynchronous	642.56.802
	90	Synchronous with lateral locking mechanism	642.59.922
		Asynchronous	642.57.008
1200	60	Synchronous	642.59.903
	90	Asynchronous	642.57.009

Packing: 1 set

### Order reference

The set does not include 8 table top connecting fittings and 4 locking hooks or 4 swivel lugs. Please order separately.

### → For 2 extension leaves

Synchronous with continuous, lateral locking mechanism



For 2–4 people more at the table



> Area of application: Also suitable for glass tables

### Installation

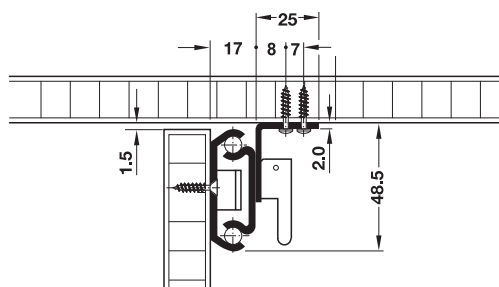

### Technical data

Load bearing capacity	kg	90
Opening for extension leaves	mm	840
Width of extension leaves	mm	1–2 x 400
Total extension length	mm	1750
Mounting bracket length	mm	370
Recommended table length	mm	1250–1800

### Note on choice of pull out table fitting

Installation length of pull out table fitting = approx. length of frame/ base or approx. 2/3 of table diameter or table length without extension leaves

Installation length mm	Load bearing capacity kg	Cat. No.
1200	90	642.57.112

Packing: 1 set

### Order reference

The set does not include 12 table top connecting fittings and 2 locking hooks or 2 swivel lugs. Please order separately.

Table top connecting fittings	► FF 11.15
Looking hook	► FF 11.15
Swivel lug	► FF 11.15
Folding fitting	► FF 11.14

## Roller runners

- > Material: Aluminium
- > Finish: Bright
- > Installation: For screw fixing

For 2 people more at the table



→ **For 1 extension leaf**  
Synchronous with pull cable



### Installation

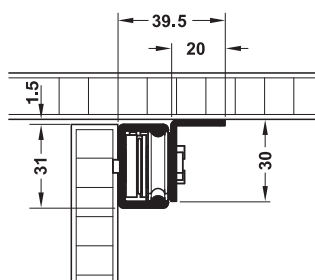

#### Technical data

Load bearing capacity	kg	60
Opening for extension leaf	mm	530
Width of extension leaf	mm	500
Total extension length	mm	1034
Mounting bracket length	mm	250

Installation length mm	Cat. No.
800	642.68.901

Packing: 1 set

→ **For 1 extension leaf**



### Installation

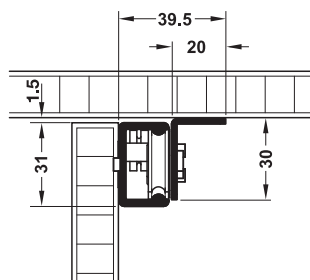

#### Technical data

Load bearing capacity	kg	60	60
Installation length	mm	800	1000
Opening for extension leaf	mm	550	700
Width of extension leaf	mm	1 x 500	1 x 600
Mounting bracket length	mm	250	300

Installation length mm	Cat. No.
800	642.68.921
1000	642.68.922

Packing: 1 set

## Folding fitting

For extension leaf

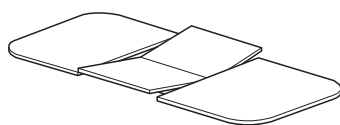

- > Area of application: For folding and lowering an extension leaf up to max. 500 mm
- > Functionality: Semi-automatic lowering, smooth operation

### Note

These items are only suitable for extending table runners for tables with frame.

### → For extension leaf, for open table frame

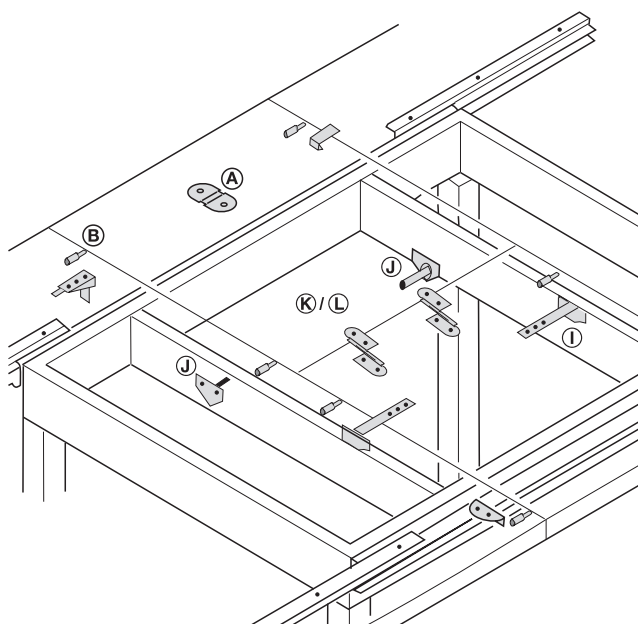

- (A) Leaf handle
- (B) Table top connecting fitting
- (J) Supporting bracket
- (K/L) Folding table hinge
- (I) Pivot bearing

#### Supplied with

- 1 leaf handle (A)
- 8 table top connecting fittings (B)
- 2 spring clips
- 1 pair of pivot bearings (I)
- 2 supporting brackets (J)
- 2 folding table hinges (K)
- 1 set of installation instructions

For panel thickness mm	Cat. No.
19	642.47.501
22	642.47.511

Packing: 1 set

### → For extension leaf, for closed table frame

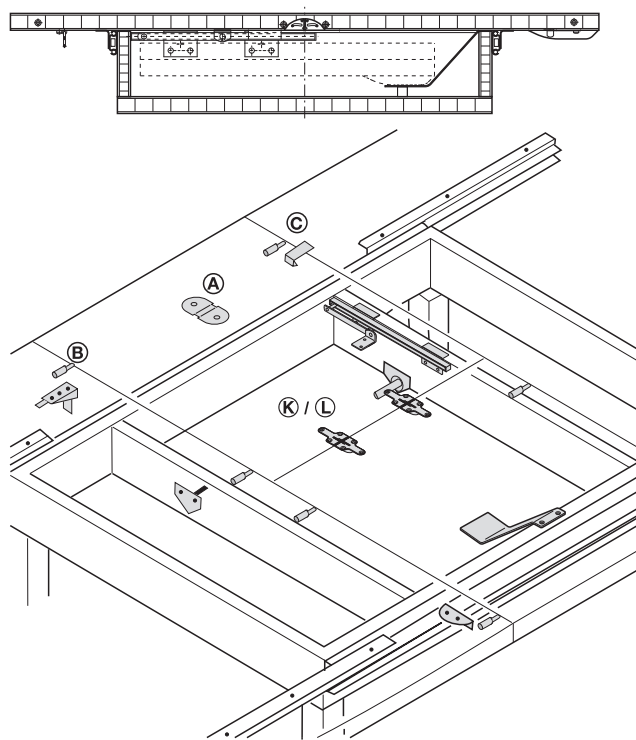

- (A) Leaf handle
- (B) Table top connecting fitting
- (C) Locking hook 52 mm
- (J) Supporting bracket
- (K/L) Folding table hinge
- (I) Pivot bearing

#### Supplied with

- 1 drive each side, right and left
- 1 sliding support each side, right and left
- 1 inclined piece, 1 runner
- 1 leaf handle, 4 locking hooks, 1 set of installation instructions

For panel thickness mm	Cat. No.
16–32	642.47.521

Packing: 1 set

#### Order reference

The set does not include 8 table top connecting fittings and 2 folding table hinges. Please order separately.

Table top connecting fittings	► FF 11.15
Folding table hinges	► FF 11.17
Pull out table fittings for tables with frame	► FF 11.12

## Folding fitting individual components

### → Leaf handle **(A)**

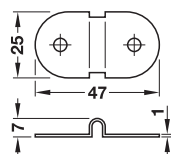

- > Material: Steel
- > Finish: Nickel plated
- > Installation: For screw fixing to extension leaf

	Cat. No.
Leaf handle <b>(A)</b>	642.51.300

Packing: 1 or 50 pieces

### → Table top connecting fitting **(B)**

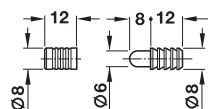

- > Material: Steel
- > Finish: Blue galvanized
- > Installation: For press fitting into Ø 8 mm drill holes

	Cat. No.
Table top connecting fitting <b>(B)</b>	642.51.241

Packing: 20, 100 or 1000 pieces

### → Locking hook 52 mm **(C)**

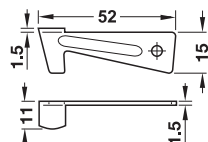

- > Material: Steel
- > Finish: Blue galvanized
- > Installation: For screw fixing beneath table top

	Cat. No.
Locking hook <b>(C)</b>	642.51.226

Packing: 1 or 100 pieces

### → Locking hook 53 mm **(D)**

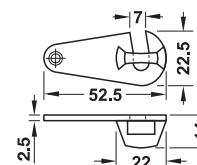

- > Material: Zinc alloy
- > Finish: Nickel plated
- > Installation: For screw fixing beneath table top

	Cat. No.
Locking hook <b>(D)</b>	642.51.230

Packing: 1 or 100 pieces

### → Swivel lug **(E)**

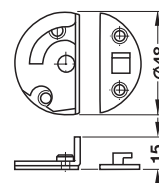
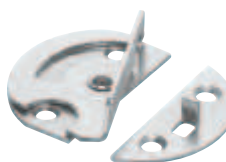

- > Material: Steel
- > Finish: Galvanized
- > Installation: For mounting in drilled hole or screw fixing beneath table top
- > Material thickness: 1.5 mm

	Cat. No.
Swivel lug <b>(E)</b>	642.48.921

Packing: 1 or 100 pieces

### → Swivel lug **(F)**

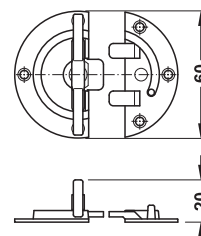

- > Material: Steel
- > Finish: Brass plated
- > Installation: For mounting in drilled hole or screw fixing beneath table top

	Cat. No.
Swivel lug <b>(F)</b>	642.48.530

Packing: 1 or 100 pieces

## → Spring clip

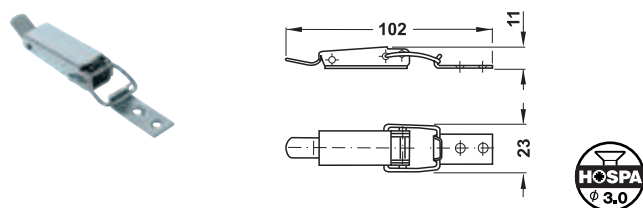

- > Material: Steel
- > Finish: Galvanized
- > Installation: For screw fixing beneath table top

	Cat. No.
Spring clip	380.52.925
Packing: 1 or 100 pieces	

## → Spring clip with locking mechanism

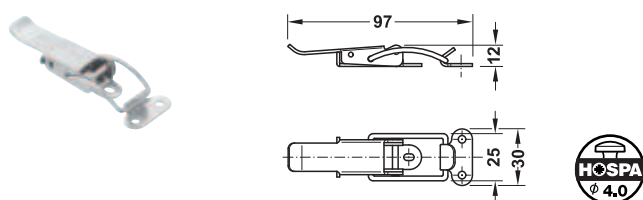

- > Material: Steel
- > Finish: Blue galvanized
- > Installation: For screw fixing beneath table top

	Cat. No.
Spring clip with locking mechanism	380.51.904
Packing: 1 or 100 pieces	

## → Pivot bearing ①

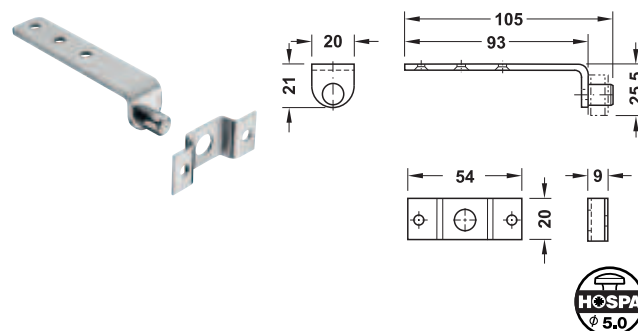

- > Material: Steel
- > Finish: Blue galvanized
- > Installation: For screw fixing beneath extension leaf

	Cat. No.
Pivot bearing ①	642.48.505
Packing: 1 or 50 pairs	

## → Supporting bracket ①

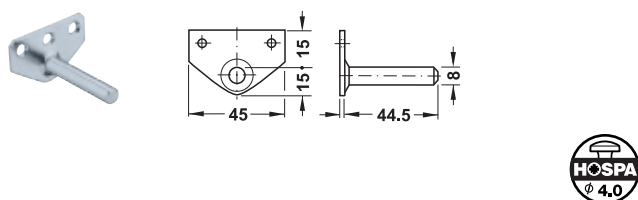

- > Material: Steel
- > Finish: Blue galvanized
- > Installation: For screw fixing beneath table frame

	Cat. No.
Supporting bracket ①	642.48.514
Packing: 1 or 200 pieces	

## → Folding table hinge (K)

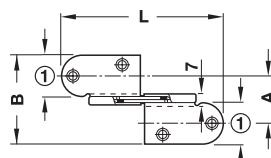

① 21 mm; 23 mm (from table top thickness 28 mm)

- > Material: Steel
- > Finish: Blue galvanized
- > For panel thickness: With internal joint 16–25 mm, with external joint 28–32 mm
- > Installation: For recess mounting

### Installation

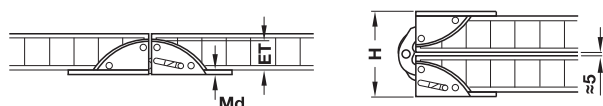

The provided 2 mm plates must be placed beneath 16 mm table top leaves.

For panel thickness mm	Recess depth ET mm	L x W mm	Height H mm	A mm	Material thickness Md mm
16	14	85 x 47	46	25	1.5
18	16	85 x 47	46	25	1.5
21	19	85 x 51	51	28	1.5
25	23	85 x 43	59	21	1.5
28	25	133 x 50	63	26	1.7
30	27	133 x 46	67	23	1.7
32	29	133 x 41	71	18	1.7

### Functionality

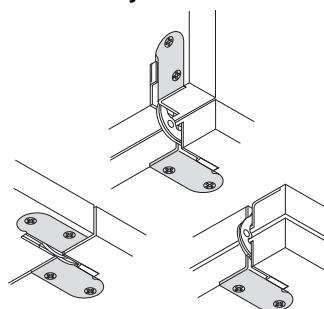

For panel thickness mm	Cat. No.
16	341.30.536
18	341.30.509
21	341.30.527
25	341.30.546
28	341.30.551
30	341.30.561
32	341.30.572

Packing: 1 or 100 pieces

## → Folding table hinge (L)



For panel thickness  
18–20 mm

For panel thickness  
22–27 mm

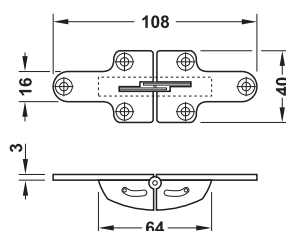

Folding table hinge

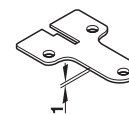

Half spacer plate

- > Material: Zinc alloy
- > Finish: Blue galvanized
- > For wood thickness: 18–27 mm
- > Installation: For recess mounting
- > Supplied with: With half spacer plates, quantity in accordance with table below

### Installation

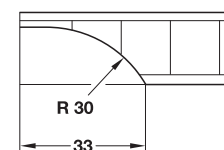
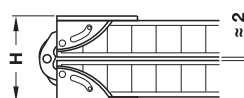

For panel thickness mm	Half spacer plates	Recess depth mm	Height H mm
18	4	15	48
19	2	16	48
20	—	17	48
22	4	19	56
23	2	20	56
24	—	21	56
25	4	22	62
26	2	23	62
27	—	24	62

For panel thickness mm	Packing pieces	Cat. No.
18	1	341.31.506
19	1	341.31.507
20	1 or 50	341.31.530
22	1	341.31.508
23	1	341.31.509
24	1 or 50	341.31.534
25	1	341.31.510
26	1	341.31.511
27	1 or 50	341.31.537



## Ball bearing runners

### → For 1–3 extension leaves

Synchronous with continuous cord retainer



- > **Installation length 850 mm:** For 2–4 people more at the table
- > **Installation length 1,200 mm:** For 2–6 people more at the table



- > **Material:** Steel
- > **Finish:** Galvanized
- > **Installation:** For screw fixing beneath table top

### Installation

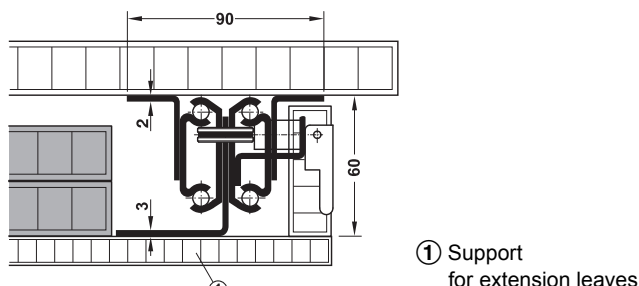

Table with frame

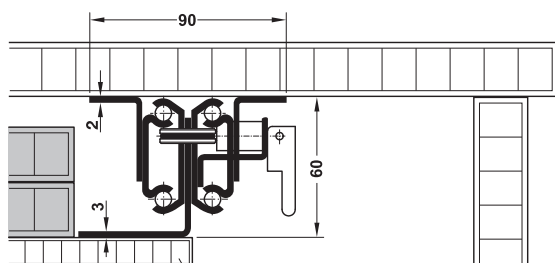

Table without frame

### Technical data

Installation length	mm	850	1,200
Load bearing capacity	kg	90	90
Opening for extension leaf	mm	1050	1590
Width of extension leaf	mm	1–2 x 500	1–3 x 500
Total extension length	mm	1900	2790
Mounting bracket length	mm	725	725
Recommended table length	mm	900–1250	1250–1800

### Installation length

mm	Cat. No.
850	642.59.912
1200	642.59.915

Packing: 1 set

### Order reference

The set does not include top connecting fittings and spring clips. Please order separately.

### → For 1–4 extension leaves

Synchronous with continuous cord retainer

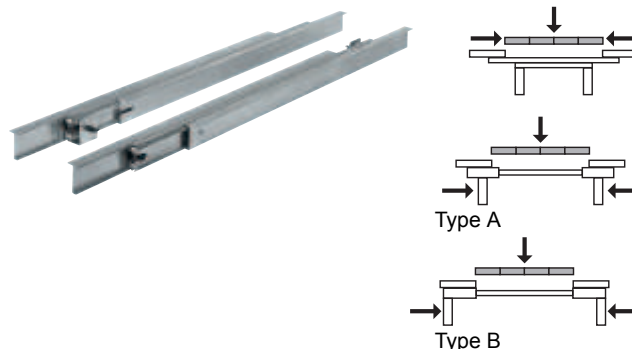

For 2–8 people more at the table



- > **Material:** Aluminium
- > **Finish:** Silver coloured anodized
- > **Installation:** For screw fixing beneath table top

### Installation

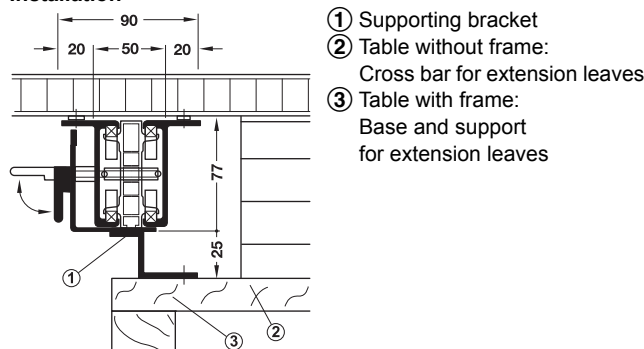

### Wooden table top

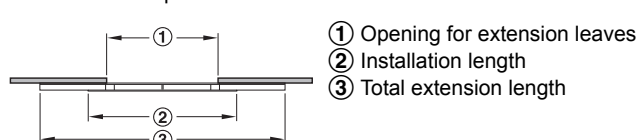

### Technical data

Installation length	mm	1200	1600
Load bearing capacity of table with frame	kg	150	150
Load bearing capacity of table without frame, type A	kg	120	150
Load bearing capacity of table without frame, type B	kg	150	120
Opening for extension leaves	mm	1760	1850
Width of extension leaves	mm	1–4 x 400	1–3 x 600
Total extension length	mm	2960	3450
Mounting bracket length	mm	1125	1600
Recommended table length	mm	1250–1800	1650–2400

### Installation length

mm	Cat. No.
1200	642.21.897
1600	642.21.898

Packing: 1 set

### Order reference

- > Other sizes available on request
- > The set does not include 20 table top connecting fittings and 2 spring clips. Please order separately.

## Ball bearing runners

For 1 folding extension leaf

- > One-sided front extension "drawer principle"
- > Pull out profile aluminium, silver coloured anodized
- > For 2 people more at the table



- > Area of application: For extending tables with front extension on one side
- > Material: Aluminium
- > Finish: Silver coloured anodized
- > Installation: For screw fixing to table top

### Functionality

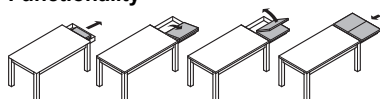

One folding extension leaf

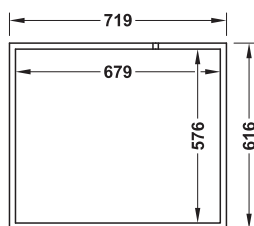
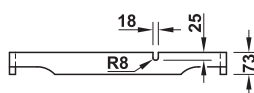

Extension leaf frame

### Installation

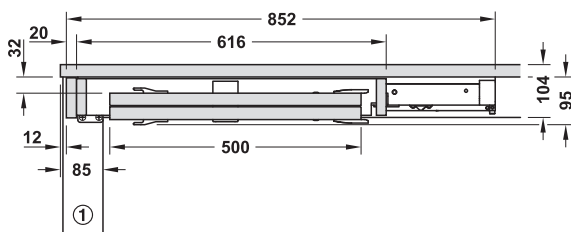

### Technical data

Load bearing capacity	kg	90
Opening for extension leaves	mm	630
Width of extension leaves	mm	1 x 500
Total extension length	mm	1483

### Note

The table length must be at least 1,900 mm when using front extensions for each front side.

### Supplied with

- 1 set of table leaf extension runners
- 1 set of folding fittings
- 1 set of installation instructions

Installation length mm	Cat. No.
830	642.29.930

Packing: 1 set

## Ball bearing runners

- > For 2 people more at the table



- > Material: Steel
- > Finish: Galvanized
- > Installation: For screw fixing beneath table top

→ For 1 extension leaf  
Asynchronous

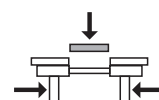

### Installation

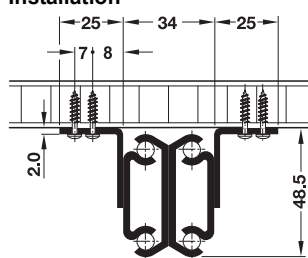

### Technical data

Load bearing capacity	kg	90
Opening for extension leaf	mm	640
Width of extension leaf	mm	1 x 600
Total extension length	mm	1160
Mounting bracket length	mm	305
Recommended table length	mm	570–800

### Note on choice of pull out table fitting

Installation length of pull out table fitting = approx. length of frame/base or approx. 2/3 of table diameter or table length without extension leaves

Installation length mm	Cat. No.
520	642.69.205

Packing: 1 set

### Order reference

The set does not include 8 table top connecting fittings and 4 spring clips or 4 swivel lugs or 4 locking hooks. Please order separately.

## Ball bearing runners

- > Material: Steel
- > Finish: Galvanized
- > Installation: For screw fixing beneath table top

### → For 2 extension leaves Asynchronous

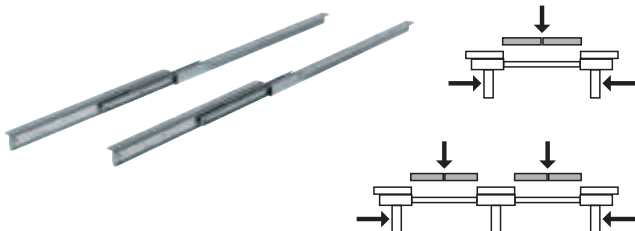

For 2–4 people more at the table

#### Installation

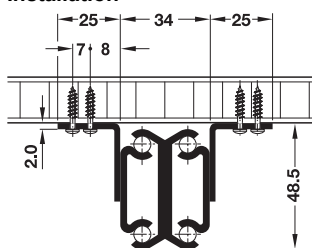

#### Technical data

Installation length	mm	740	1200	1600
Load bearing capacity	kg	90	90	90
Opening for extension leaves	mm	1080	1080	1280
Width of extension leaves	mm	1–2 x 500	1–2 x 500	1–2 x 600
Total extension length	mm	1820	1820	2880
Mounting bracket length	mm	400	725	725
Recommended table length	mm	790–1200	1250–1800	1650–2400

#### Note on choice of pull out table fitting

Installation length of pull out table fitting = approx. length of frame/ base or approx. 2/3 of table diameter or table length without extension leaves

Installation length mm	Cat. No.
740	642.69.207
1200	642.69.208
1600	642.69.209

Packing: 1 set

#### Order reference

The set does not include 12 table top connecting fittings and 6 spring clips or 6 swivel lugs or 6 locking hooks. Please order separately.

Table top connecting fittings	► FF 11.15
Looking hook	► FF 11.15
Swivel lug	► FF 11.15
Spring clips	► FF 11.16

### → For 2 or 3 extension leaves Asynchronous, with central rod

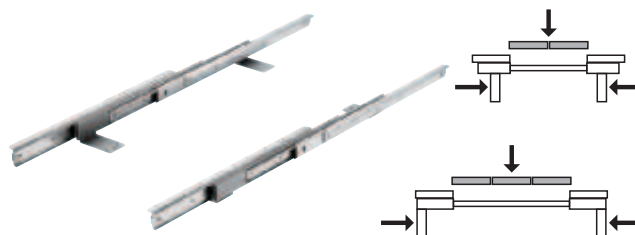

For 2–6 people more at the table

- > Version: With central rod for improved stability
- > Material: Runners and central rod: Steel
- > Finish/colour: Runners: Galvanized, central rod: Powder coated, white aluminium, RAL 9006

#### Installation

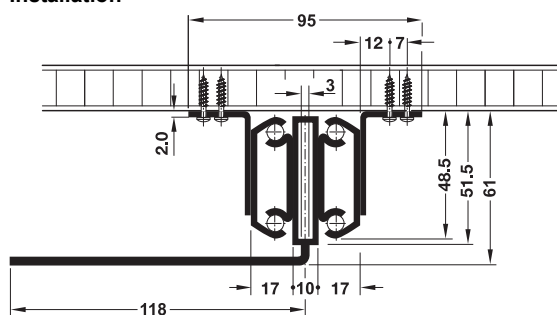

#### Technical data

Installation length	mm	860	1200	1600
Load bearing capacity	kg	90	90	90
Opening for extension leaves	mm	1120	1560	1560
Width of extension leaves	mm	1–2 x 500	1–3 x 500	1–3 x 500
Total extension length	mm	1980	2760	3160
Mounting bracket length	mm	725	725	725
Recommended table length	mm	910–1200	1250–1800	1650–2400

#### Note on choice of pull out table fitting

Installation length of pull out table fitting = approx. length of frame/ base or approx. 2/3 of table diameter or table length without extension leaves

#### Note

Installing a support foot on site is recommended with installation length 1,600 mm.

Installation length mm	Cat. No.
860	642.59.932
1200	642.59.935
1600	642.59.936

Packing: 1 set

#### Order reference

The set does not include 12 table top connecting fittings and spring clips or 6 swivel lugs or 4 locking hooks. Please order separately.

## → For 3 extension leaves

Asynchronous

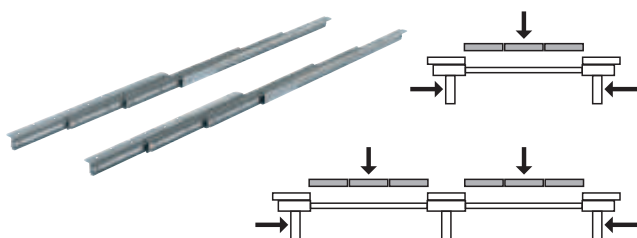

For 2–6 people more at the table



- > Material: Steel
- > Finish: Galvanized
- > Installation: For screw fixing beneath table top

### Installation

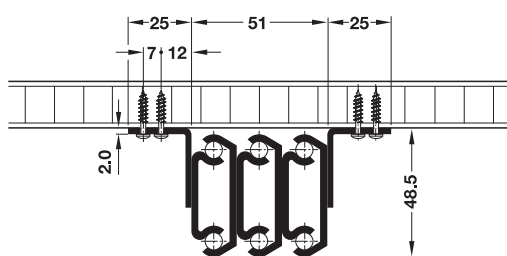

### Technical data

Load bearing capacity	kg	90
Opening for extension leaves	mm	1620
Width of extension leaves	mm	1–3 x 500
Total extension length	mm	2360
Mounting bracket length	mm	605
Recommended table length	mm	790–1100

### Note on choice of pull out table fitting

Installation length of pull out table fitting = approx. length of frame/ base or approx. 2/3 of table diameter or table length without extension leaves

Installation length mm	Cat. No.
740	642.69.307

Packing: 1 set

### Order reference

The set does not include 16 table top connecting fittings and 8 spring clips or 8 swivel lugs or 8 locking hooks. Please order separately.

## → For 4 extension leaves

Asynchronous, with hinged telescopic support foot

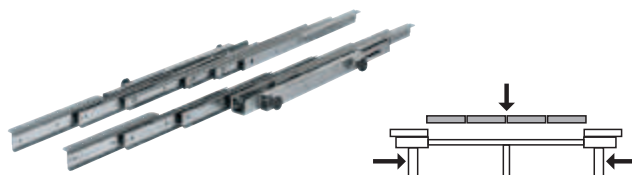

For 2–8 people more at the table



- > Material: Runners and support foot: Steel
- > Finish/colour: Runners: Galvanized, support foot: Powder coated, white aluminium, RAL 9006
- > Installation: For screw fixing beneath table top

### Installation

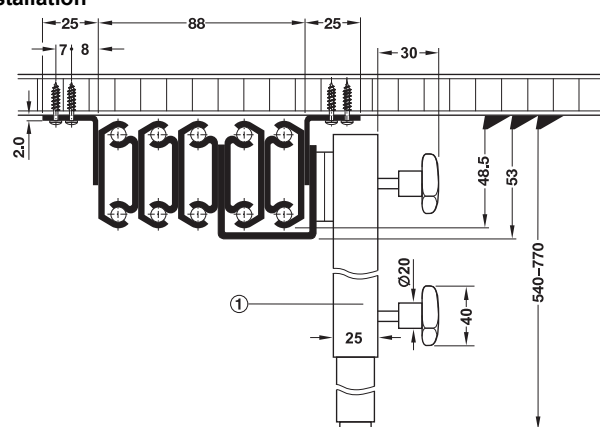

### ① Support foot

### Technical data

Installation length	mm	620	1200
Load bearing capacity	kg	90	90
Opening for extension leaves	mm	2100	2560
Width of extension leaves	mm	1–4 x 500	1–5 x 500
Total extension length	mm	2720	3760
Mounting bracket length	mm	340	725
Recommended table length	mm	670–1000	1250–1800

### Note on choice of pull out table fitting

Installation length of pull out table fitting = approx. length of frame/ base or approx. 2/3 of table diameter or table length without extension leaves

Installation length mm	Cat. No.
620	642.69.506
1200	642.56.508

Packing: 1 set

### Order reference

The set does not include 20 table top connecting fittings and 10 spring clips or 10 swivel lugs or 10 locking hooks. Please order separately.

Table top connecting fittings	► FF 11.15
Looking hook	► FF 11.15
Swivel lug	► FF 11.15
Spring clips	► FF 11.16

## Ball bearing runners

For 1 or 2 folding extension leaves

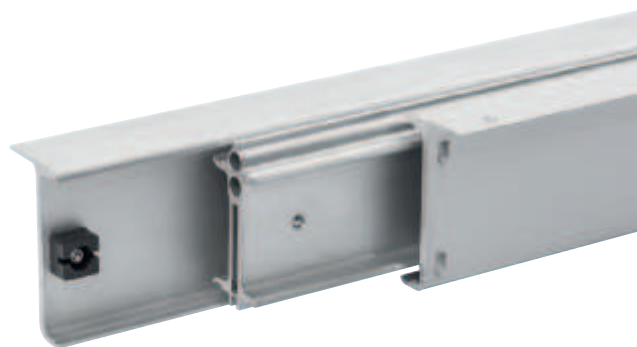

- > Pull out profile aluminium, silver coloured anodized
- > For 2–4 people more at the table



### Functionality

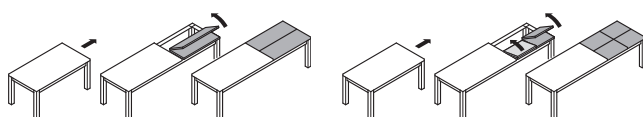

One folding extension leaf

Two folding extension leaves

### Installation

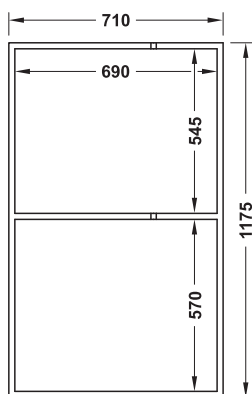
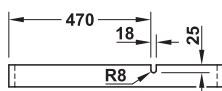
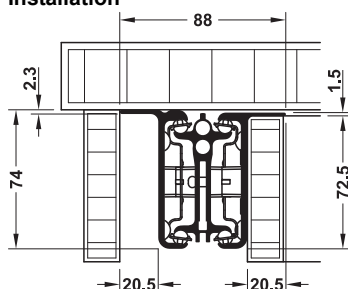

Extension leaf frame with two folding extension leaves:  
Dimensions exemplary for folding extension leaf 2 x 500 mm, table width 1,000 mm

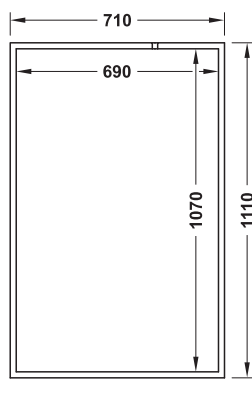
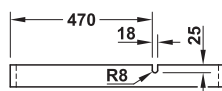

Extension leaf frame with one folding extension leaf:  
Dimensions exemplary for folding extension leaf 1 x 1,000 mm, table width 1,000 mm

- > Area of application: For extending tables with frame, one-side extension
- > Material: Runners: Aluminium, folding fitting: Steel
- > Finish: Runners: Silver coloured anodized, folding fitting: Galvanized
- > Installation: For screw fixing to table top and pull out frames

### Technical data

Installation length	mm	940	1400	1800
Load bearing capacity	kg	115	115	115
Opening for extension leaves	mm	1130	1130	1130
Width of extension leaves	mm	1 x 1000 or 2 x 500		
For table top length	mm	1040–1500	1500–1900	1900–2400

### Note

Pull out frame for fixing the folding fittings must be manufactured on site in accordance with the installation instructions.

### Supplied with

- 1 set of table leaf extension runners
- 1 set of folding fittings
- 2 inset castors
- Installation instructions

Installation length mm	Cat. No.
940	642.25.931
1400	642.25.934
1800	642.25.936

Packing: 1 set

### Order reference

Please order folding table hinges for folding extension leaf separately.

### Pull out table fitting, self-supporting



- > Pull out table instead of a drawer, maintains uniform front design
- > Seating for up to 5 people



#### Functionality

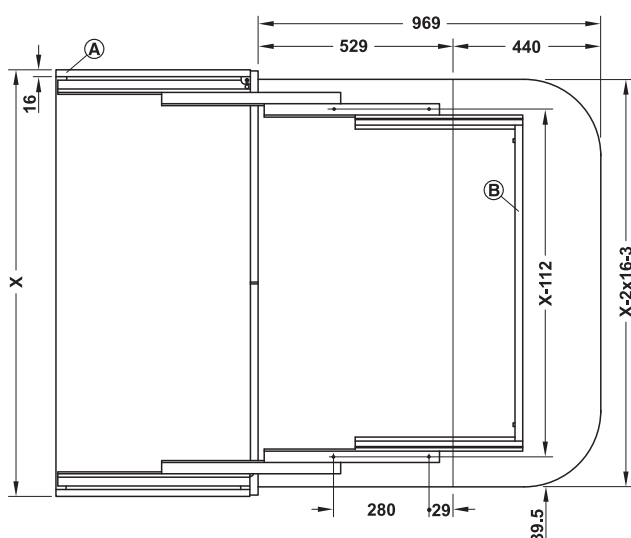
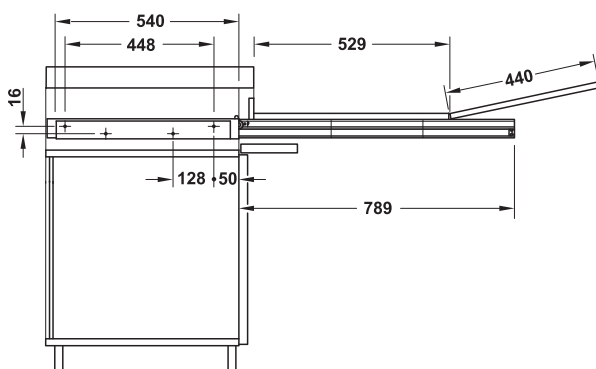
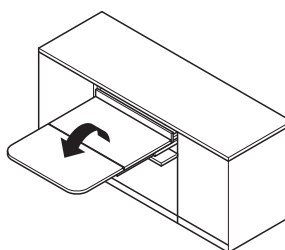
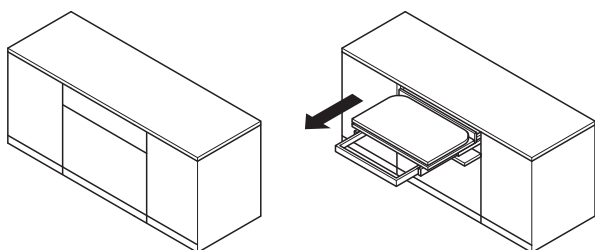

- > Area of application: For kitchen and living room furniture, behind folding drawer front panels
- > Material: Guide profile: Aluminium, mechanism: Steel
- > Finish: Guide profile: Silver coloured anodized, mechanism: Galvanized
- > Internal installation depth: Min. 540 mm
- > Dim.: Table top: Length 969 mm, table top width = internal cabinet width – 3 mm
- > Load bearing capacity: 60 kg

#### Supplied with

1 pair of running tracks  
Fixing material  
Installation instructions  
Without table top

For cabinet width mm	Cat. No.
600	505.73.944
900	505.73.945
1200	505.73.946

Packing: 1 set

#### Order reference

Table top not supplied. Please order hinges for drawer front panel and folding table hinges separately.

#### Note

Attention!

Secure cabinet to prevent toppling!

The system is designed to suit side panel thickness **A** 16 mm.

The connecting profile **B** must be shortened by 1.5 mm on both sides when using 19 mm thick side panels.

Folding table hinges	► FF 4.120
	► FF 11.6
Flap stay with braking mechanism and pull cable	► FF 4.238
Flap hinge	► FF 4.260

### Pull out table fitting and folding fitting with folding table leg

- > For accommodating a pull out table in place of a drawer
- > Seating for up to 7 people

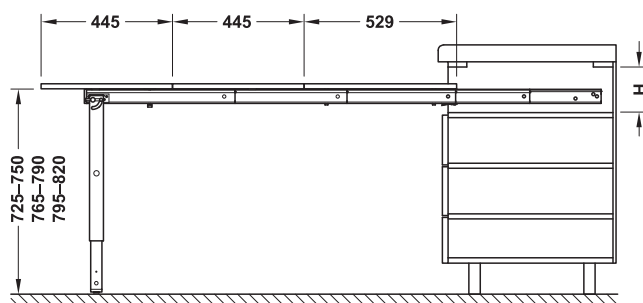

- > Area of application: For kitchen and living room furniture, can be installed in place of a drawer to provide a uniform front design
- > Material: Guide profiles: Aluminium, table leg: Steel
- > Finish/colour: Aluminium: Silver coloured anodized, steel: White aluminium
- > Internal installation depth:  $\geq 560$  mm
- > Internal installation height: Dim. H  $\geq$  (83 mm + 3 x table top thickness)
- > Load bearing capacity: Approx. 60 kg
- > Version: With folding table leg

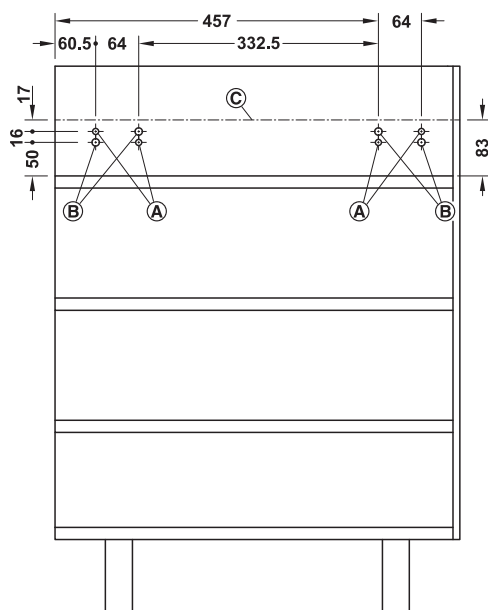

Side view

- Ⓐ Ø 8 mm, depth: 13 mm
- Ⓑ Ø 10 mm, min. depth: 3.5 mm
- Ⓒ Top edge of fitting

**Supplied with**  
1 fitting set

Internal installation width mm	Cat. No.
562	642.19.927
862	642.19.928
1162	642.19.929

Packing: 1 set

#### Order reference

Table top not supplied.  
Please order 6 folding table hinges, 1 inset handle and fittings for drawer front panel separately.

Folding table hinge	► FF 4.120
Flap hinges	► FF 4.260
Flap stay with pull cable	► FF 4.234 ► FF 4.238



TKB Drop leaf table fitting

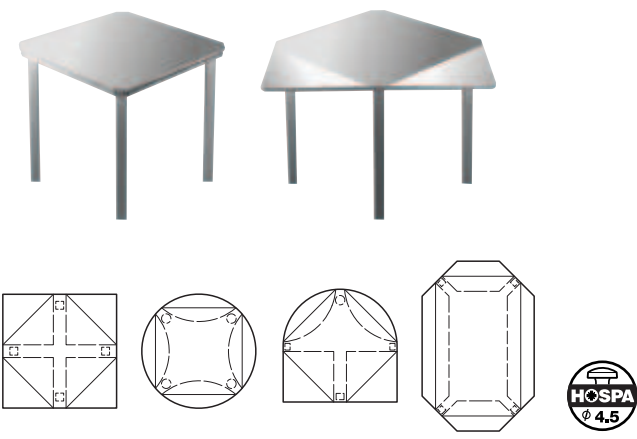

> Area of application: For extending the table top by folding out  
> Installation: For screw fixing

- Supplied with**
- 1 TKB drop leaf table fitting
  - 1 sliding support
  - 1 guide profile
  - 2 flexible hinges
  - 1 double ball catch
  - 1 stop buffer

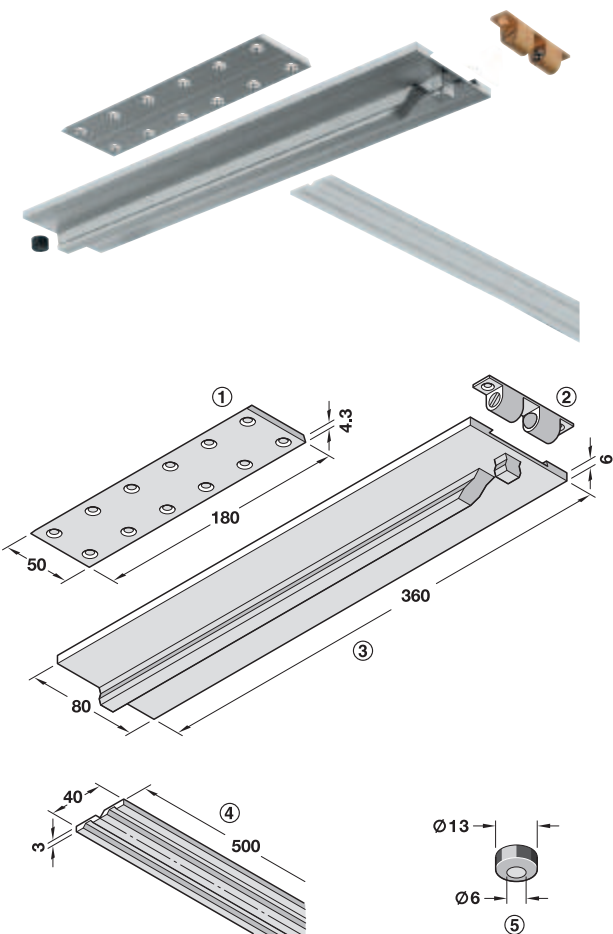

- 1 Guide profile
- 3 Sliding support
- 5 Stop buffer
- 2 Double ball catch
- 4 Flexible hinge

Installation

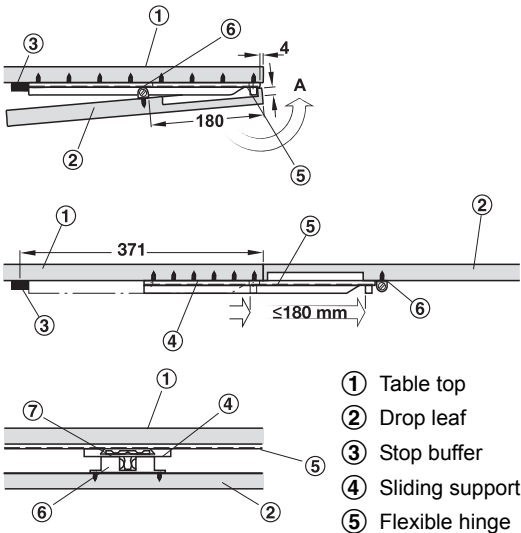

- 1 Table top
- 2 Drop leaf
- 3 Stop buffer
- 4 Sliding support
- 5 Flexible hinge
- 6 Double ball catch, serves as stop
- 7 Guide profile
- A Groove: 14 mm wide, 12 mm deep

Sample measurements

- > Depth approx. 250 mm
- > Install one fitting at width intervals of approx. 600 mm
- > Load bearing capacity approx. 20 kg

Functionality

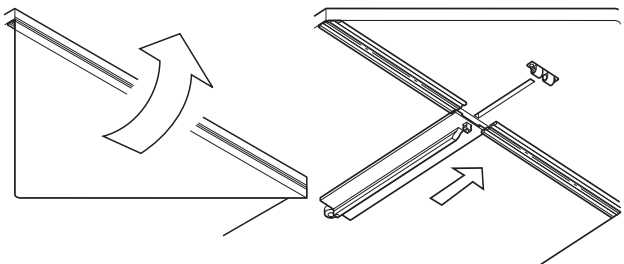

The drop leaf is folded away and held by the ball catch.

The drop leaf is raised and the sliding support must be pulled out.

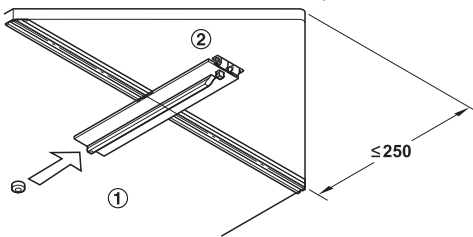

The extended sliding support supports the drop leaf.

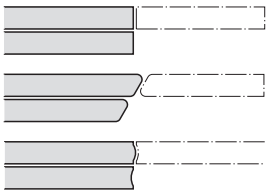

Possible table edge profiles

	Cat. No.
Drop leaf table fitting	642.40.008

Packing: 1 set

DGH-M-INT 2020, HDE-en, 05/19; Dimensional data not binding. We reserve the right to alter specifications without notice.



**Bracket**

Folding

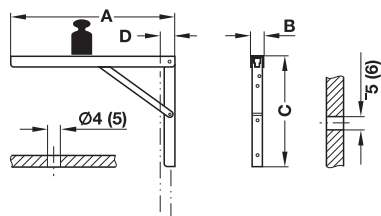
Fixing holes for  
top mountingFixing holes for  
wall mounting

Dimensions in brackets apply to dim. A = 400 mm

- > Material: Steel
- > Version: With locking mechanism adjustable in 3 positions

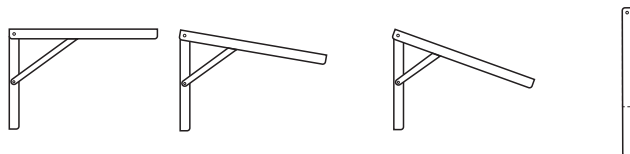
**Adjustment facility**

Position 1 = 90° Position 2 = 80° Position 3 = 70° Position 4 = 0°

**Functionality**

To raise bracket lift support arm and allow to engage at required position.  
To fold down bracket lift support arm and release locking mechanism.

Dim. A mm	Dim. B mm	Dim. C mm	Dim. D mm	Galvanized	White coated
300	30	200	25	287.55.930	287.55.730
400	36	270	32	287.55.940	287.55.740

Packing: 1 or 2 pieces

**Bracket for table extension**

Folding

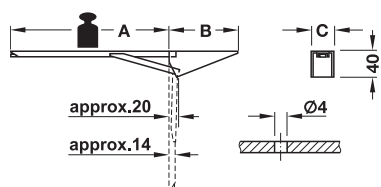
approx.20  
approx.14

- > Material: Steel



For extending table tops and worktops.  
The sprung folding bracket automatically  
locks when raised.

Dim. A mm	Dim. B mm	Dim. C mm	Yellow chromatized
280	130	30	287.41.951

Packing: 1 or 30 pieces

Swivel support for additional table top

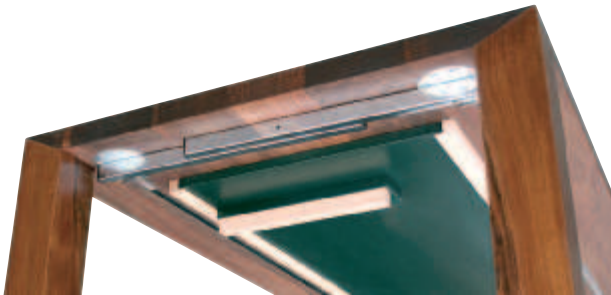
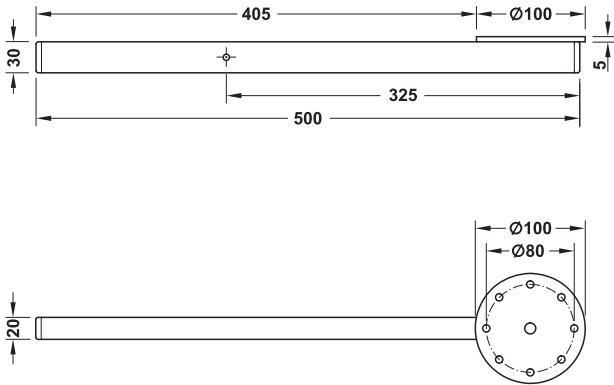

- > Area of application: For extending tables with additional table top
- > Material: Steel
- > Finish: Galvanized
- > Dim.: Additional table top width: 400–600 mm
- > Installation: For screw fixing to table top
- > Load bearing capacity: Approx. 80 kg

**Supplied with**  
2 mounting plates with swivel support  
2 stop battens with table top connecting fitting

	Cat. No.
Swivel support	641.07.900
Packing: 1 set	

→ Routing template

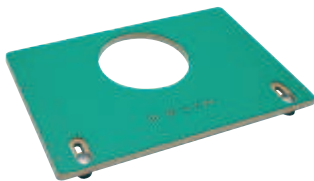

	Cat. No.
Routing template	641.07.910
Packing: 1 piece	

**Order reference**  
A jig guide Ø 24 mm and a milling cutter Ø 16 mm are also required for routing the recess.

